

Isikliku kasutusõiguse ala plaan
Harju maakond, Viimsivald, Haabneeme alevik, 11251 Viimsi-Rohuneeme tee
katastritunnus 89001:024:0005, registriosa 10254150

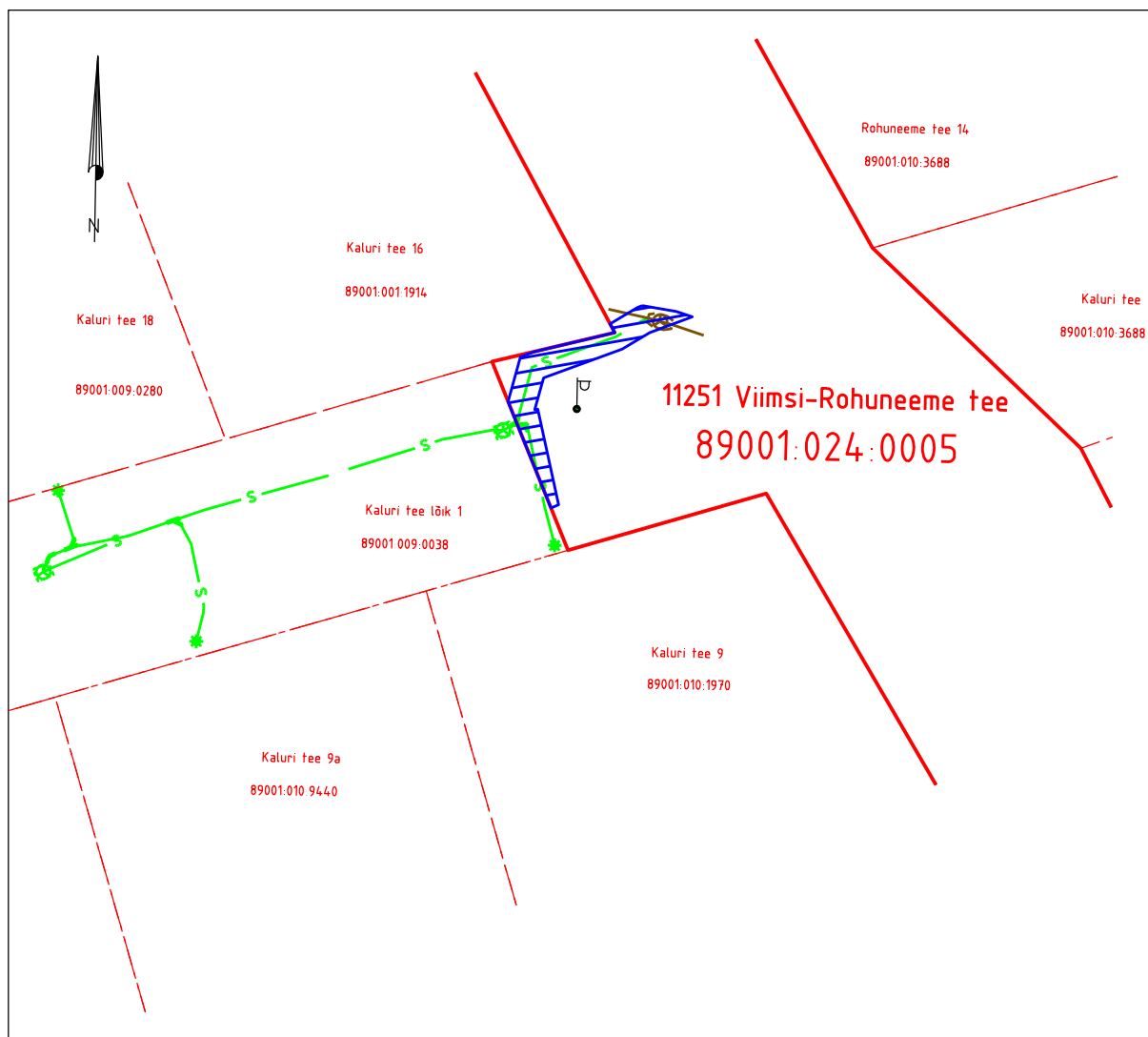





M 1:250

Koostas J.Mets

ÕÜ Raba Projekti töö nr 2777.T.24 "Kaluri tee ja Kivila tee
sidevõrgu rekonstrueerimine Haabneeme alevikus Viimsi vallas Harjumaaal"

Teostusjoonis Geoplan Eesti OÜ töö nr 24285

-  Isikliku kasutusõiguse ala 34m², PARI ID: 436623
-  Sideehitis (maakaabel)
-  Olemasolev sideehitis
-  Lepingu objektiks olev kinnistu piir
-  Kinnistupiirid