

Koormatava ala asendiplaan

Kinnistu nimi: 4 Tallinn-Pärnu-Ikla tee



Katastritunnus: 80901:001:0440

Asukoht: Nurme küla, Tori vald, Pärnu maakond

Leonhard Weiss OÜ töö nr 3071E Elektrilevi OÜ tellimus IK1172

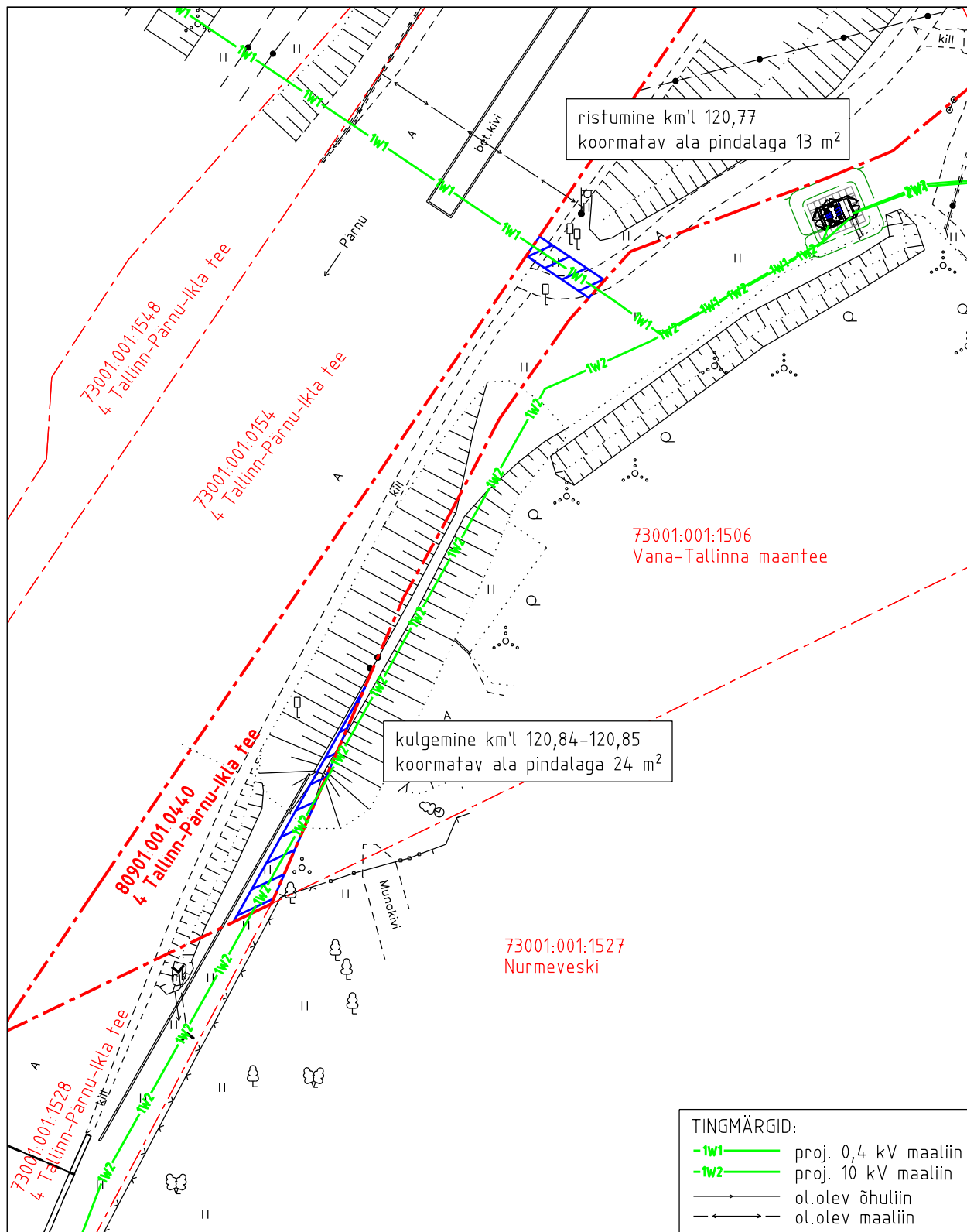
Pärnu-Jaagupi I etapp Kurena küla, Nurme küla ja Sauga alevik, Tori vald, Pärnumaa







-  Koormatava ala pindala kokku 37 m²
-  Lepingu objektiks oleva katastriüksuse piir
-  Katastriüksuste piirid

Plaan 10-1
M 1:500

Koostaja:
OÜ Leonhard Weiss

TINGMÄRGID:

-  -1W1 proj. 0,4 kV maaliin
-  -1W2 proj. 10 kV maaliin
-  ol.olev õhuliin
-  ol.olev maaliin