

ISIKLIKU KASUTUSÕIGUSEGA ALA PLAAN (leht: 1/4)

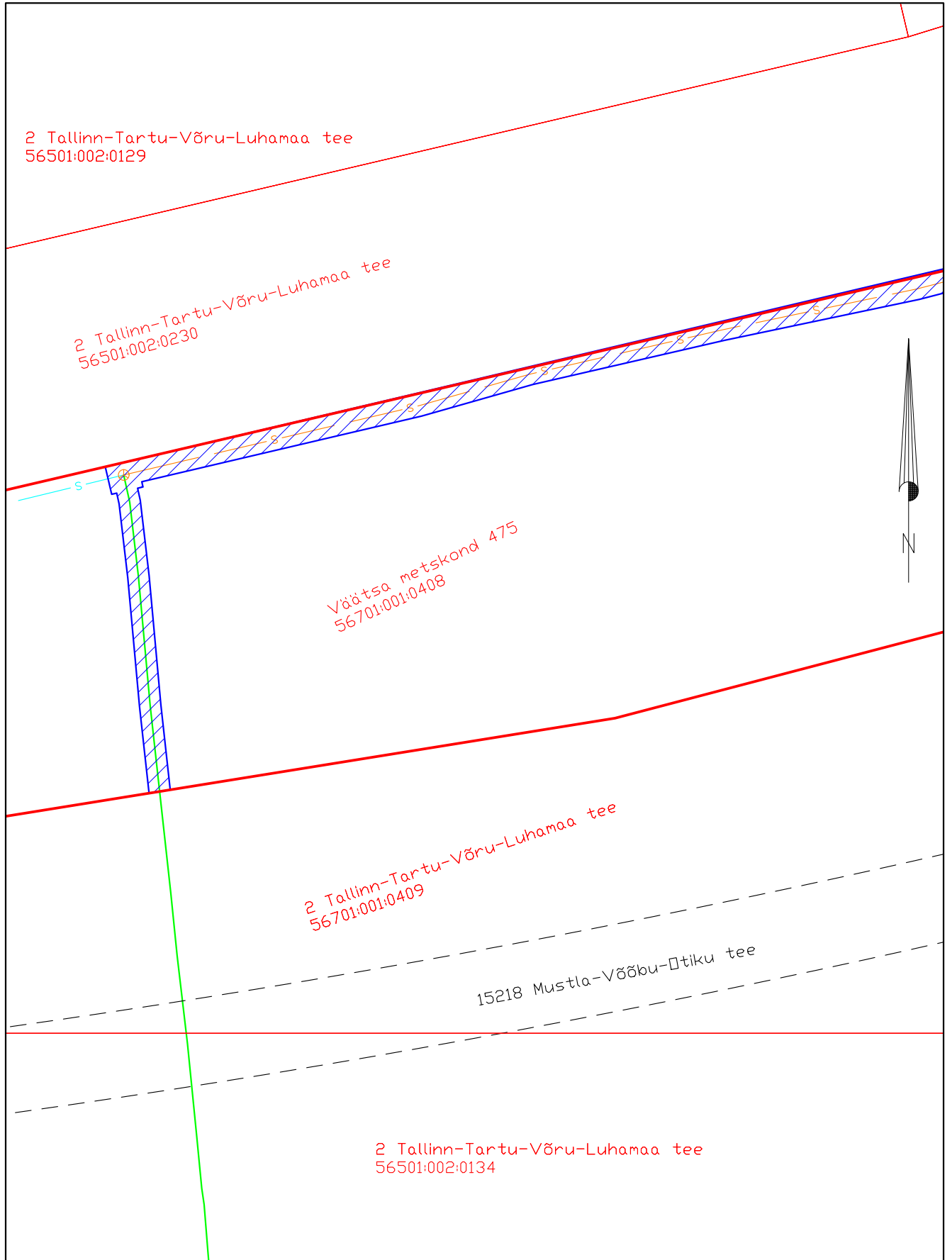



Järva maakond, Paide linn, Võõbu küla,

Väätsa metskond 475

katastritunnus 56701:001:0408, registriosa 16091950



Möötkava: M 1:500
Koostaja: Sergei Dolgušev

-  Lepingu objektiks oleva katastriüksuse piir
-  Katastriüksuste piirid
-  Projekteeritav sidetrass
-  Olemasolev ELA SA trass
-  Tööst väljaviidav ELA SA trass

 Isikliku kasutusõiguse ala 664 m²

ISIKLIKU KASUTUSÕIGUSEGA ALA PLAAN (leht: 2/4)



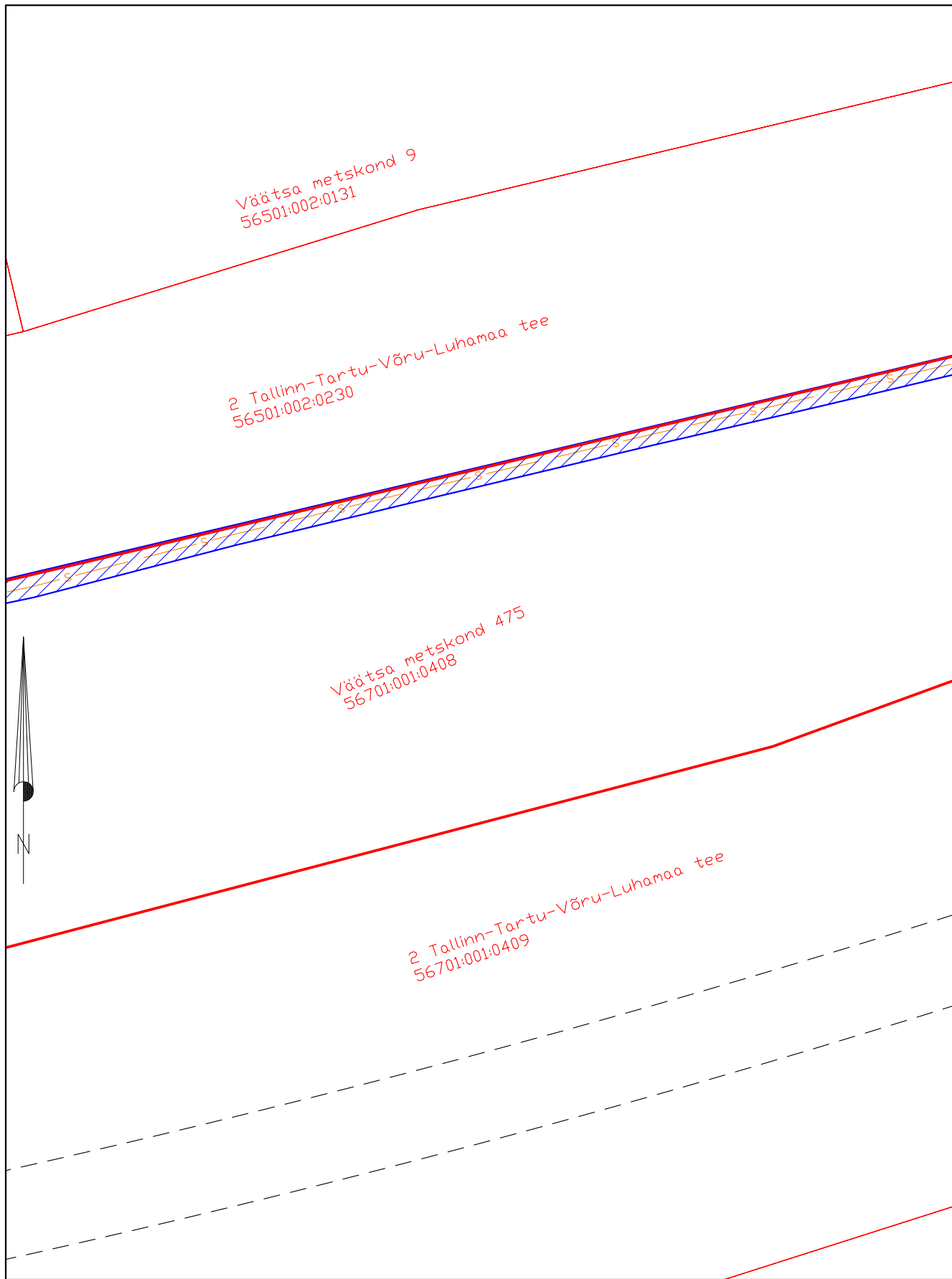

Järva maakond, Paide linn, Võõbu küla,

Väätsa metskond 475

katastritunnus 56701:001:0408, registriosa 16091950



Möötkava: M 1:500
Koostaja: Sergei Dolgušev

-  Lepingu objektiks oleva katastriüksuse piir
-  Katastriüksuste piirid
-  Projekteeritav sidetrass
-  Olemasolev ELA SA trass
-  Tööst väljaviidav ELA SA trass

 Isikliku kasutusõiguse ala 664 m²

ISIKLIKU KASUTUSÕIGUSEGA ALA PLAAN (leht: 3/4)

Järva maakond, Paide linn, Vööbu küla,



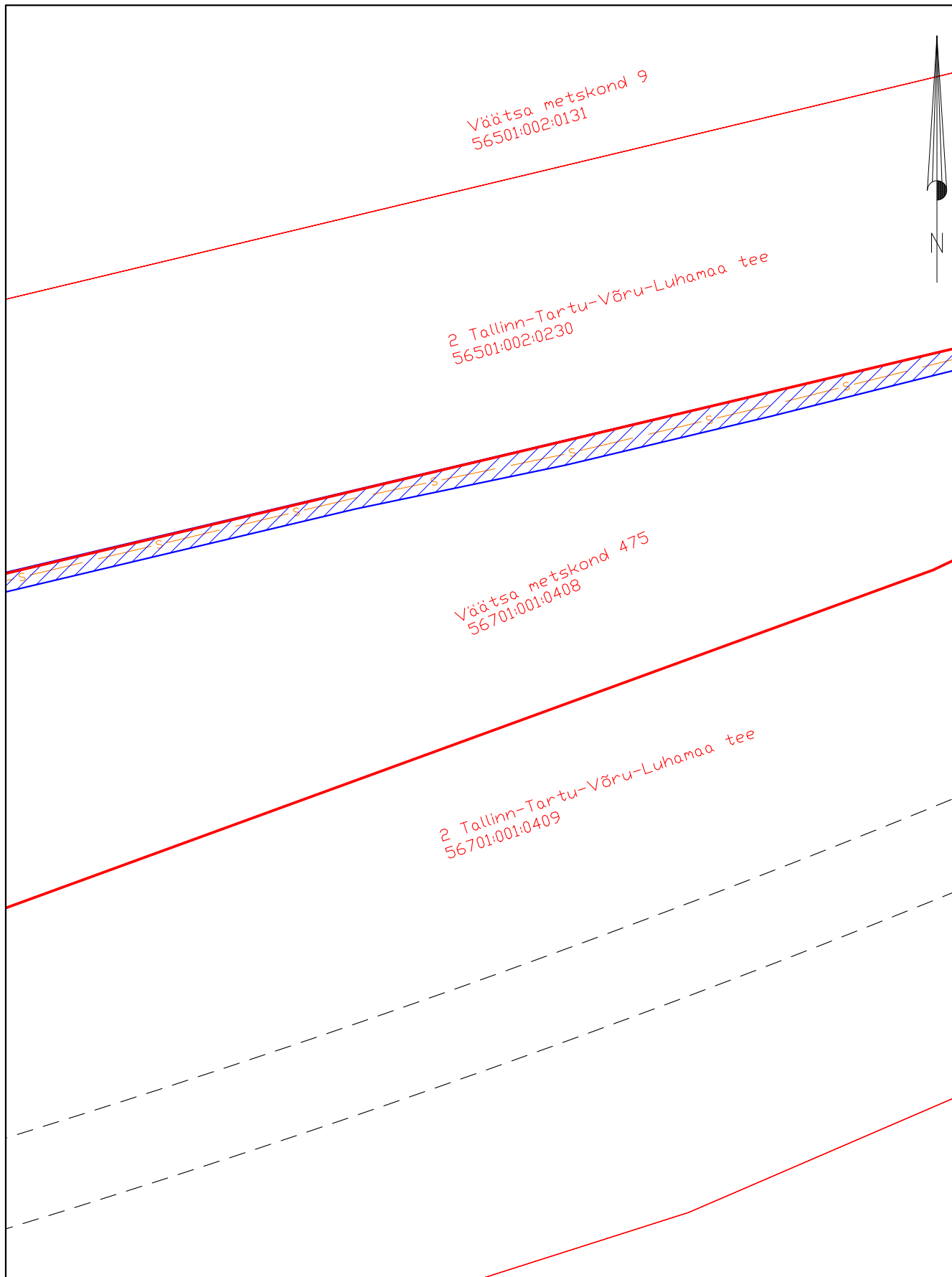

Väätsa metskond 475

katastritunnus 56701:001:0408, registriosa 16091950



Möötkava: M 1:500

Koostaja: Sergei Dolgušev

-  Lepingu objektiks oleva katastriüksuse piir
-  Katastriüksuste piirid
-  Projekteeritav sidetrass
-  Olemasolev ELA SA trass
-  Tööst väljaviidav ELA SA trass

 Isikliku kasutusõiguse ala 664 m²

ISIKLIKU KASUTUSÕIGUSEGA ALA PLAAN (leht: 4/4)



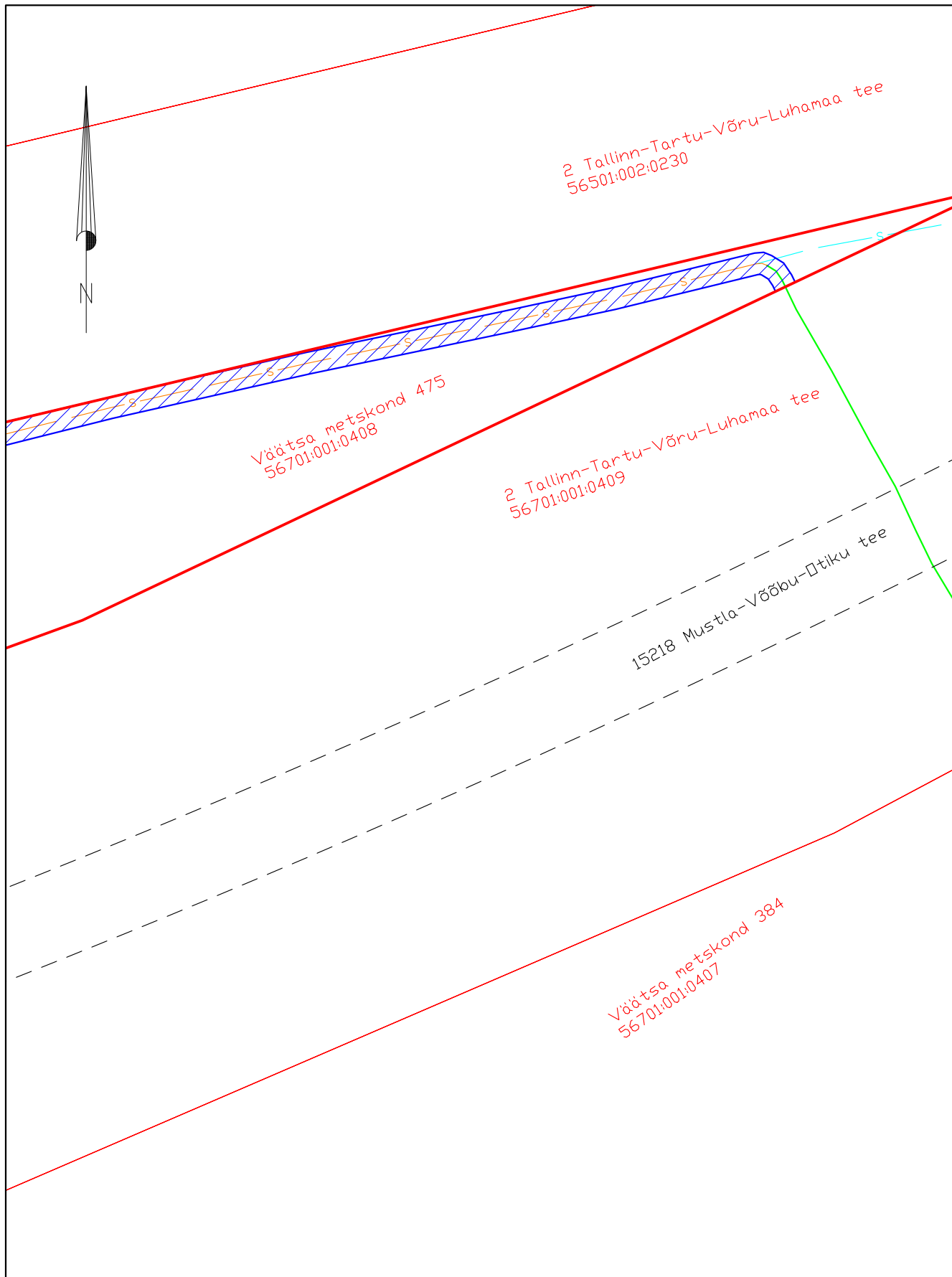

Järva maakond, Paide linn, Vööbu küla,

Väätsa metskond 475

katastritunnus 56701:001:0408, registriosa 16091950



Möötkava: M 1:500
Koostaja: Sergei Dolgušev

-  Lepingu objektiks oleva katastriüksuse piir
-  Katastriüksuste piirid
-  Projekteeritav sidetrass
-  Olemasolev ELA SA trass
-  Tööst väljaviidav ELA SA trass

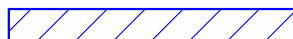
 Isikliku kasutusõiguse ala 664 m²