

Tihemetsa-Allikukivi JJT valgustus

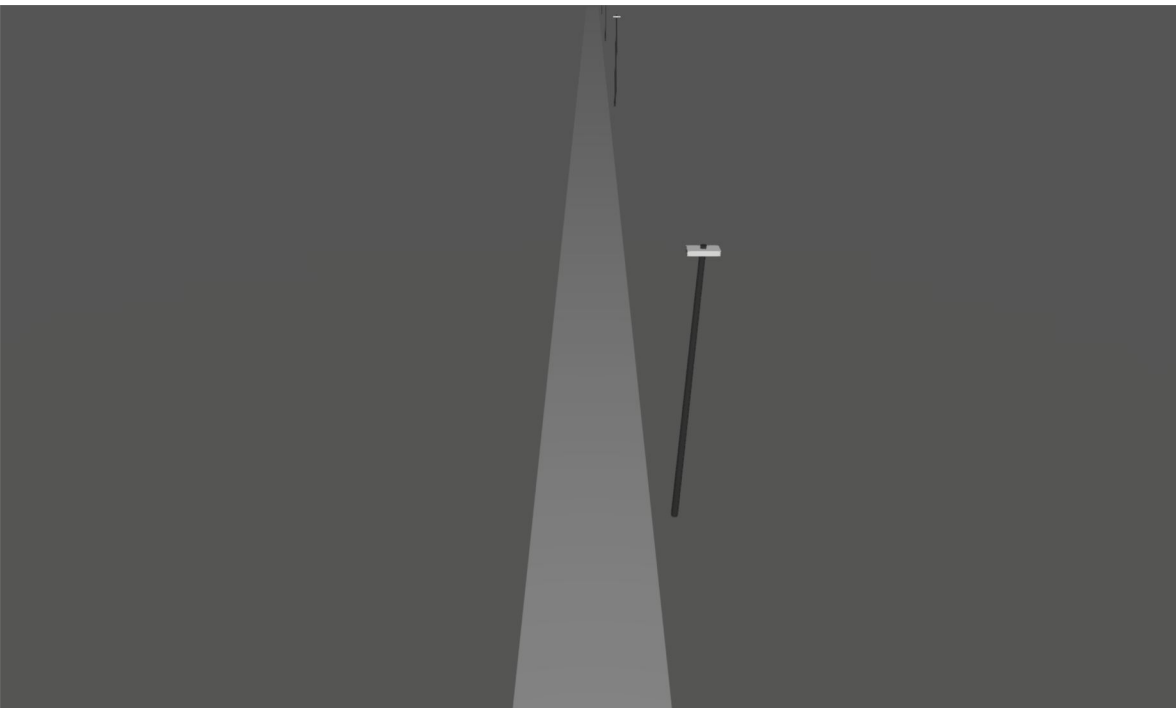

Description

Transpordiamet

Andrus Tull

Luminaire list

Φ_{total} 4848 lm	P_{total} 40.0 W	Luminous efficacy 121.2 lm/W
----------------------------------	------------------------------	---------------------------------

pcs.	Manufacturer	Article No.	Article name	P	Φ	Luminous efficacy
4	Philips	UniStreet gen2 Micro	BGP281 T25 DN10 /730	10.0 W	1212 lm	121.2 lm/W

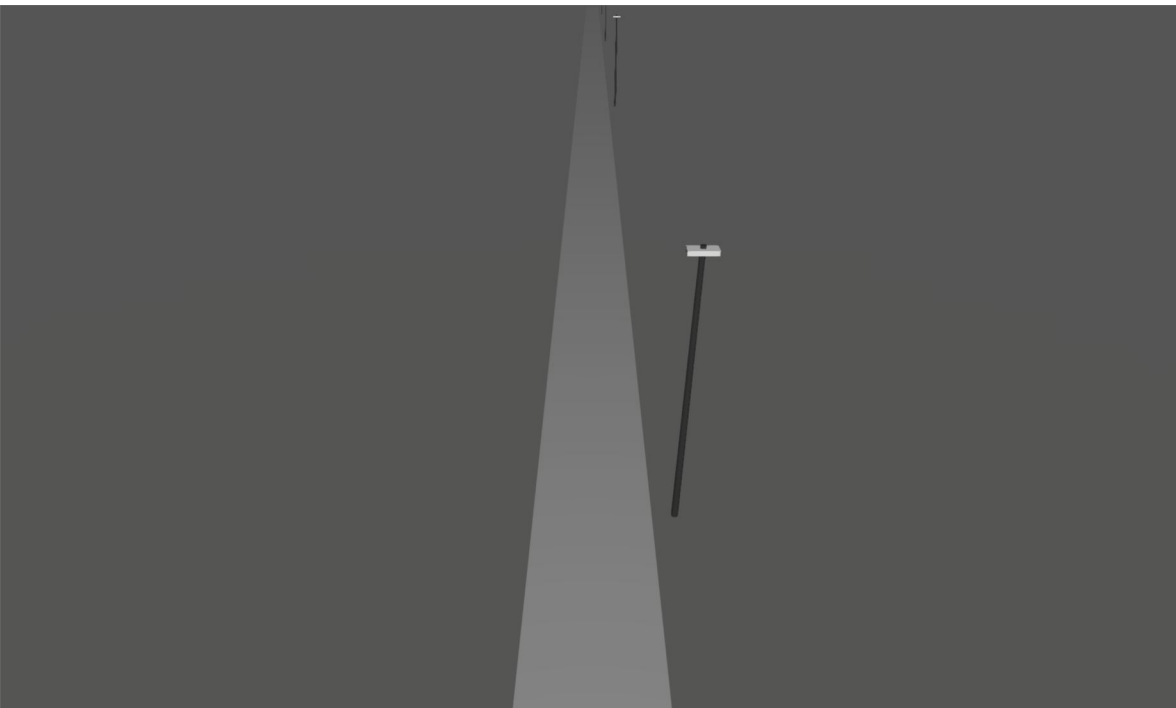

JJT P5, 3000K, 10W, 44tk.

Description

JJT P5, 3000K, 10W, 44tk.

Summary (according to EN 13201:2015)

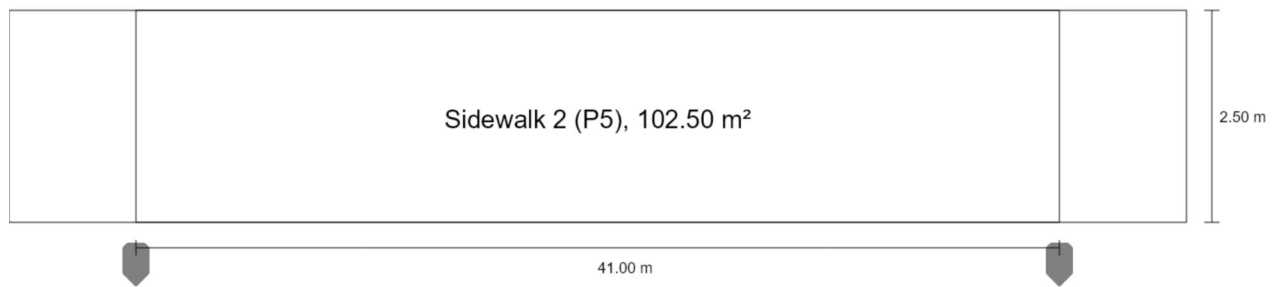

JJT P5, 3000K, 10W, 44tk.

Summary (according to EN 13201:2015)

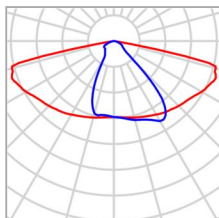
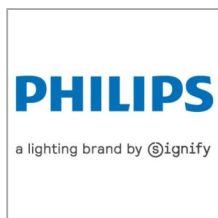

Manufacturer	Philips	P	10.0 W
Article No.	UniStreet gen2 Micro	Φ_{Lamp}	1350 lm
Article name	BGP281 T25 DN10 /730	$\Phi_{\text{Luminaire}}$	1212 lm
Fitting	1x LED14-CLO-4S @100kh	η	89.79 %

JJT P5, 3000K, 10W, 44tk.

Summary (according to EN 13201:2015)

BGP281 T25 DN10 /730 (single side bottom)

Pole distance	41.000 m
(1) Light spot height	6.000 m
(2) Light point overhang	-0.500 m
(3) Boom inclination	0.0°
(4) Boom length	0.000 m
Annual operating hours	4000 h: 100.0 %, 10.0 W
Wattage / route	240.0 W/km
ULR / ULOR	0.00 / 0.00
Max. luminous intensities Any direction forming the specified angle from the downward vertical, with the luminaire installed for use.	$\geq 70^\circ$: 633 cd/klm $\geq 80^\circ$: 136 cd/klm $\geq 90^\circ$: 0.00 cd/klm
Luminous intensity class The luminous intensity values in [cd/klm] for calculation of the luminous intensity class refer to the luminaire luminous flux according to EN 13201:2015.	G*2
Glare index class	D.6
MF	0.90



JJT P5, 3000K, 10W, 44tk.

Summary (according to EN 13201:2015)

Results for valuation fields

A maintenance factor of 0.90 was used for calculating for the installation.

	Symbol	Calculated	Target	Check
Sidewalk 2 (P5)	E_{av}	3.30 lx	[3.00 - 4.50] lx	✓
	E_{min}	0.75 lx	≥ 0.60 lx	✓

Results for energy efficiency indicators

	Symbol	Calculated	Energy Consumption
JJT P5, 3000K, 10W, 44tk.	D_p	0.030 W/lx*m ²	–
BGP281 T25 DN10 /730 (single side bottom)	D_e	0.4 kWh/m ² yr	40.0 kWh/yr

JJT P5, 3000K, 10W, 44tk.

Sidewalk 2 (P5)

Results for valuation field

	Symbol	Calculated	Target	Check
Sidewalk 2 (P5)	E_{av}	3.30 lx	[3.00 - 4.50] lx	✓
	E_{min}	0.75 lx	≥ 0.60 lx	✓

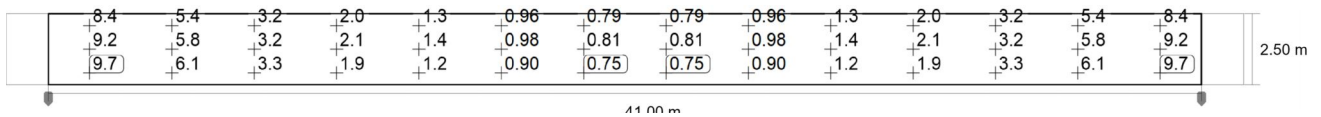
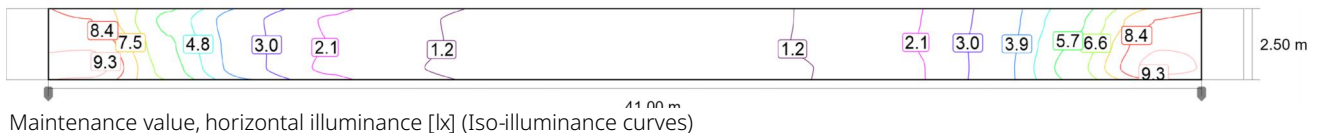

m	1.464	4.393	7.321	10.250	13.179	16.107	19.036	21.964	24.893	27.821	30.750	33.679	36.607	39.536
2.083	8.39	5.43	3.17	2.00	1.33	0.96	0.79	0.79	0.96	1.33	2.00	3.17	5.43	8.39
1.250	9.17	5.81	3.23	2.07	1.36	0.98	0.81	0.81	0.98	1.36	2.07	3.23	5.81	9.17
0.417	9.70	6.13	3.25	1.92	1.23	0.90	0.75	0.75	0.90	1.23	1.92	3.25	6.13	9.70

Maintenance value, horizontal illuminance [lx] (Value chart)

	E_{av}	E_{min}	E_{max}	U_0 (g ₁)	g ₂
Maintenance value, horizontal illuminance	3.30 lx	0.75 lx	9.70 lx	0.23	0.08