

Qty.	Description
1	<p data-bbox="196 163 486 197">UNILIFT AP50B.50.08.1V</p> <div data-bbox="328 219 464 517">  </div> <p data-bbox="592 510 1064 537">Note! Product picture may differ from actual product</p> <p data-bbox="196 544 464 571">Product No.: 96004587</p> <p data-bbox="196 577 491 611">Submersible effluent pump</p> <p data-bbox="196 645 718 734">Vertical single-stage stainless steel submersible pump with integrated submersible 1-phase motor.</p> <p data-bbox="196 768 699 857">The pump is fitted with ring stand and carrying handle and is supplied with a 10 m mains cable.</p> <p data-bbox="196 891 679 1014">The impeller is a VORTEX impeller for 50 mm free passage suitable for pumping surface water, groundwater, wastewater and similar.</p> <p data-bbox="196 1048 722 1137">The pump has a double shaft seal and an intermediate oil chamber pre-filled with non-toxic special oil.</p> <p data-bbox="196 1171 735 1261">The motor is insulation class F with thermal overload protection and has long-life deep-groove greased-for-life ball bearings.</p> <p data-bbox="196 1294 705 1384">The pump has Rp 2 inch discharge port and is ready for installation either free-standing or on an auto-coupling system.</p>

96004587 UNILIFT AP50B.50.08.1V 50 Hz

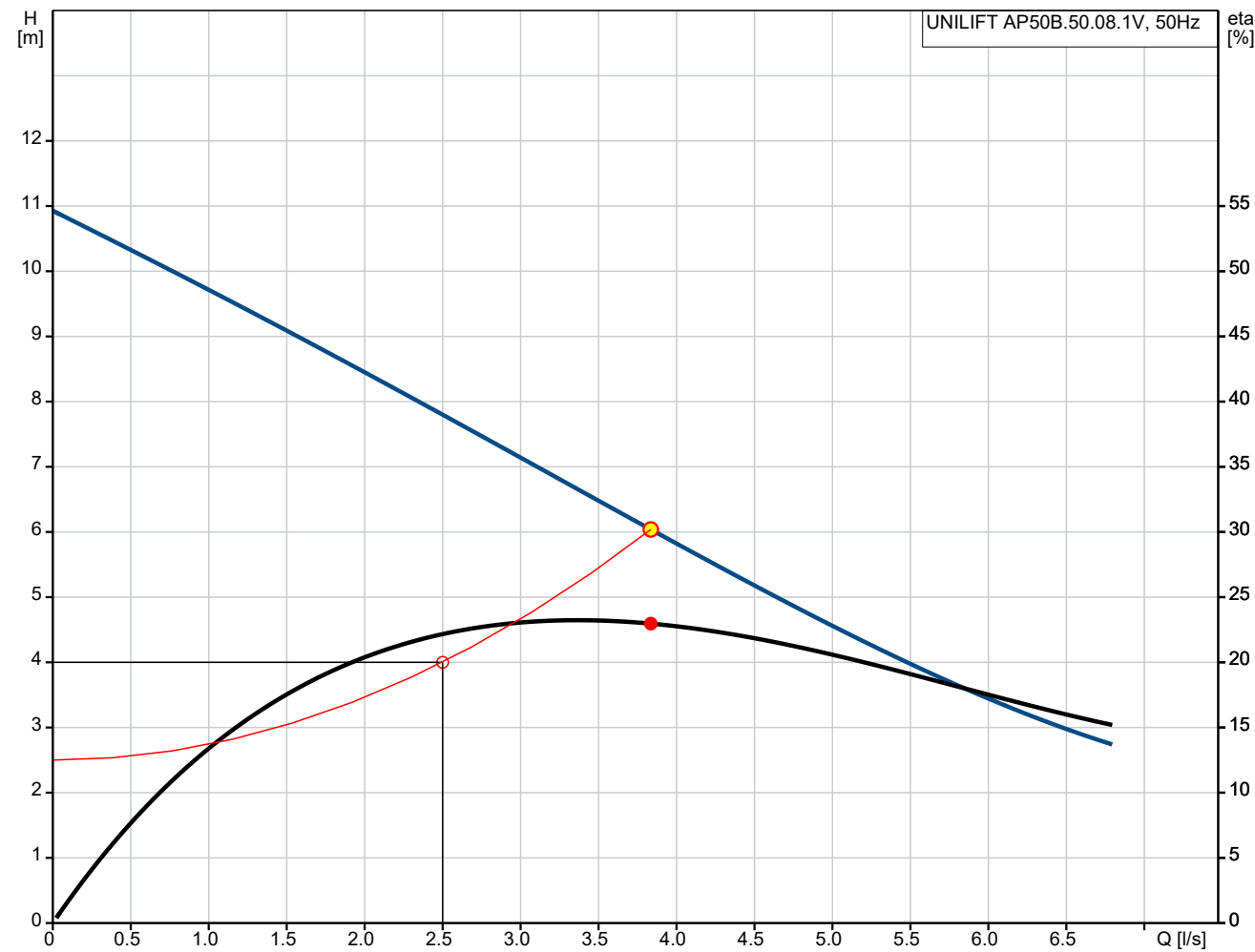

Q = 3.84 l/s
H = 6.038 m
Liquid temperature during operation = 20 °C
Eta pump+motor = 23 %

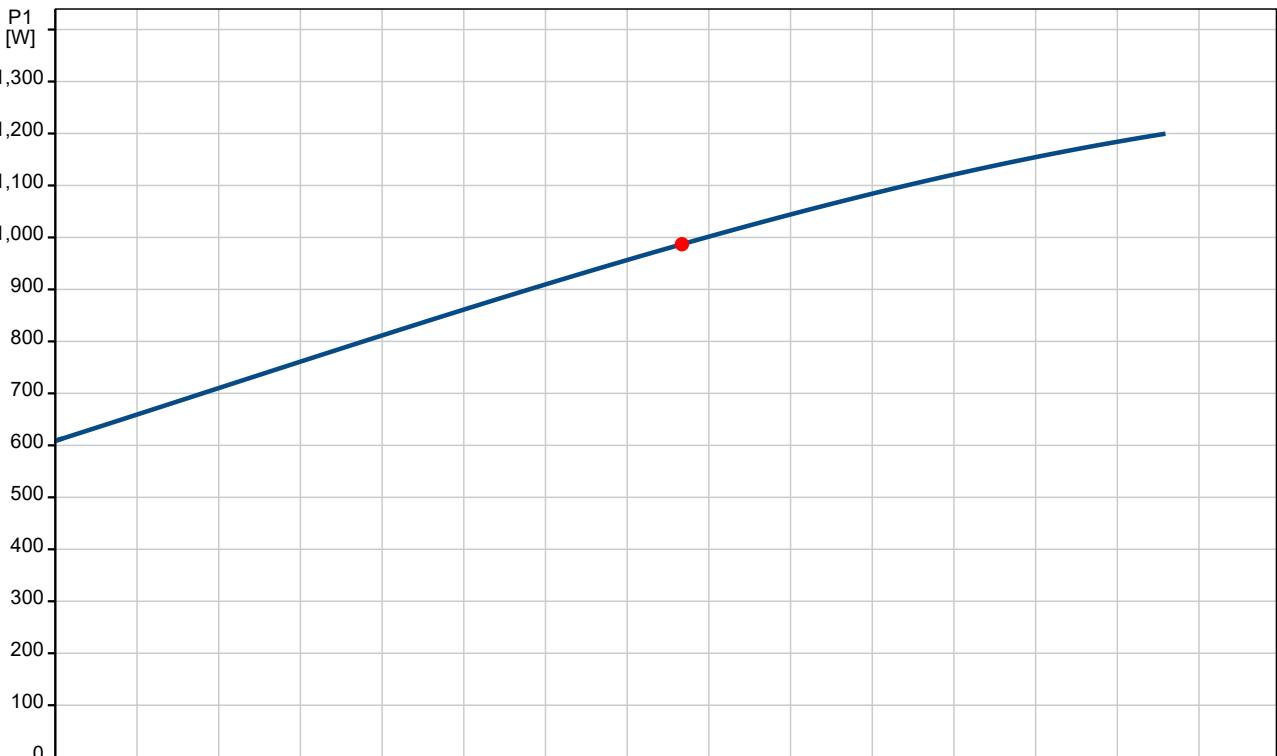

P1 = 986.9 W

Description	Value
General information:	
Product name:	UNILIFT AP50B.50.08.1V
Product No:	96004587
EAN number:	5700391489549
Technical:	
Actual calculated flow:	3.84 l/s
Maximum flow:	6.67 l/s
Resulting head of the pump:	6.038 m
Maximum head:	11 m
Type of impeller:	VORTEX
Max. Particle:	50 mm
Approvals:	CE,RCM,VDE,LGABG,EAC,MOR O,MORO,UKCA,SEPRO
Materials:	
Pump housing:	Stainless steel EN 1.4301 AISI 304
Impeller:	Stainless steel EN 1.4301 AISI 304
Installation:	
Range of ambient temperature:	0 .. 40 °C
Type of connection:	Rp
Size of connection:	2 inch
Maximum installation depth:	7 m
Inst dry/wet:	S
Installation:	H/V
Auto-coupling:	Y
Place of installation:	Indoor/outdoor
Liquid:	
Pumped liquid:	Any Newtonian liquid
Liquid temperature range:	0 .. 40 °C
Selected liquid temperature:	20 °C
Density:	998.2 kg/m³
Electrical data:	
Power input P1:	1.2 kW
Motor type 1-phase:	PSC
Rated power - P2:	0.74 kW
Mains frequency:	50 Hz
Rated voltage:	1 x 230 V
Rated current:	5.37 A
Cos phi - power factor:	0.97
Rated speed:	2790 rpm
Capacitor size - run:	16 µF/400 V
Enclosure class (IEC 34-5):	IP68
Insulation class (IEC 85):	F
Built-in motor protection:	CONTACT
Thermal protec:	internal
Length of power cable:	10 m
Type of cable plug:	SCHUKO
Others:	
Net weight:	11.5 kg
Gross weight:	12.1 kg
Danish VVS No.:	391272112
Swedish RSK No.:	5885937
Finnish LVI No.:	4822589
Environmental approvals:	WEEE

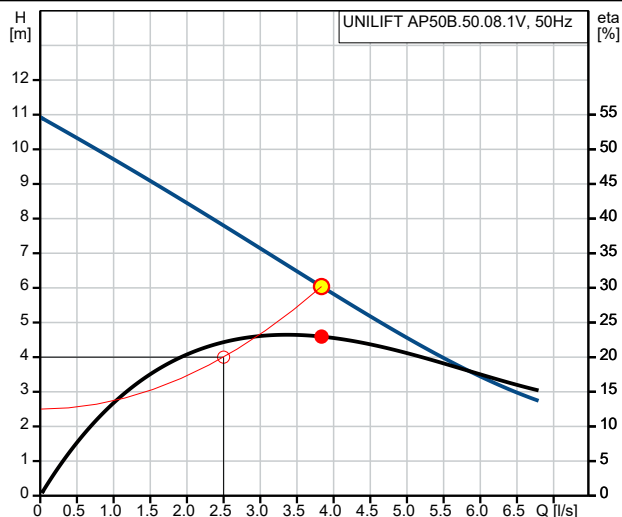

Q = 3.84 l/s
H = 6.038 m
Liquid temperature during operation = 20 °C
Eta pump+motor = 23 %

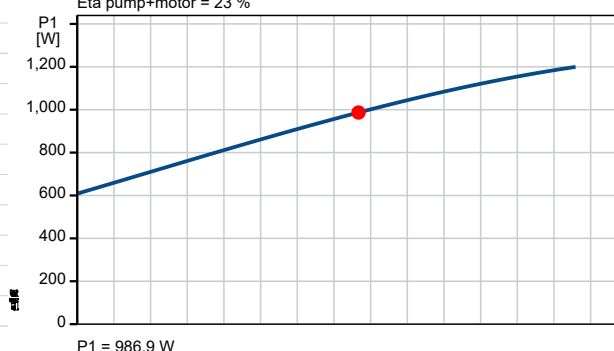

P1 = 986.9 W

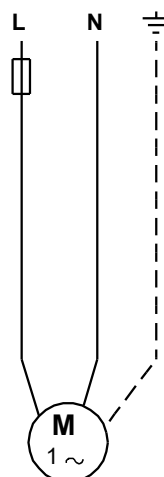
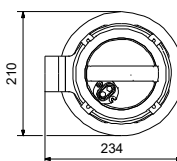
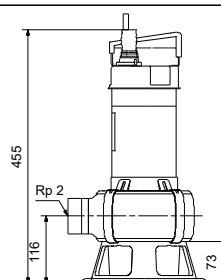

96004587 UNILIFT AP50B.50.08.1V 50 Hz

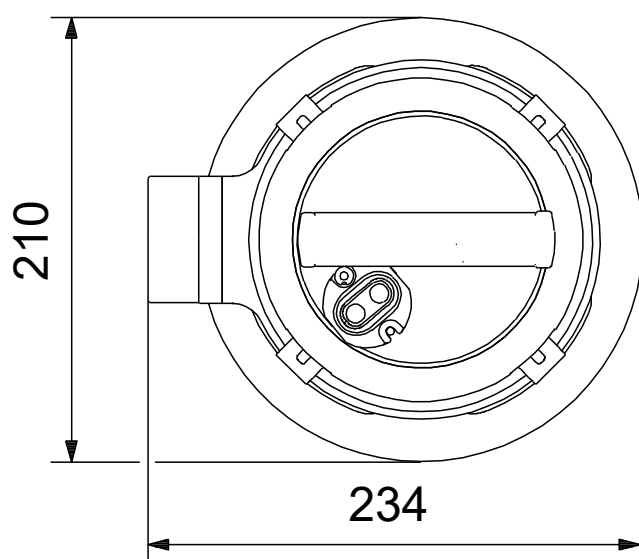
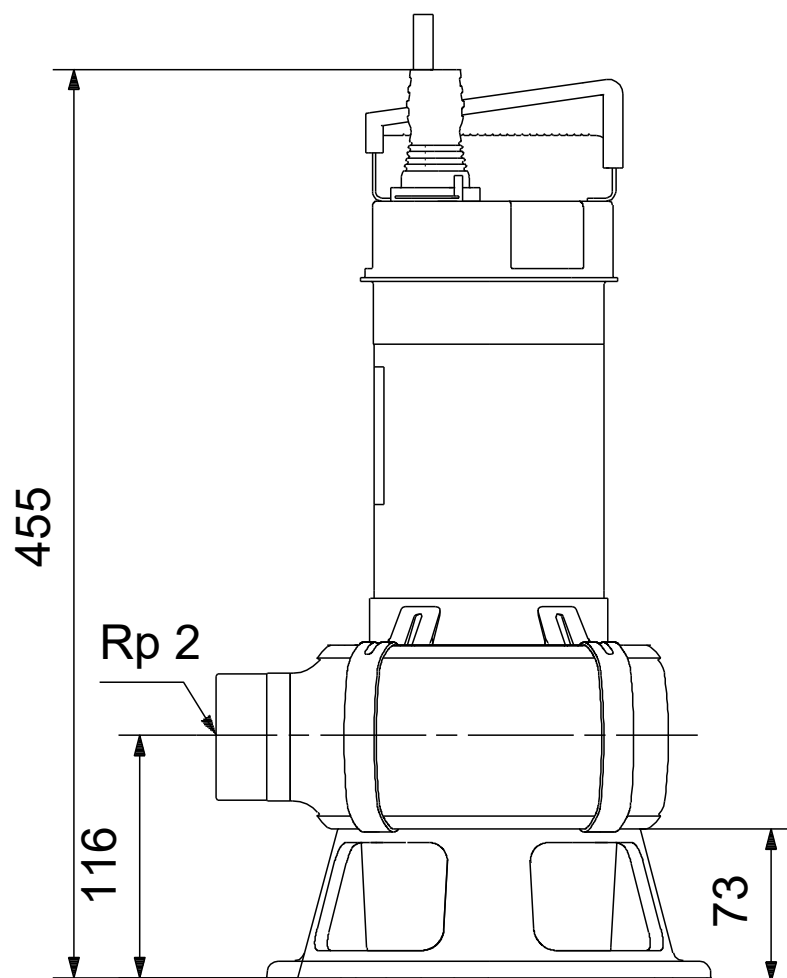

Note! All units are in [mm] unless others are stated.
Disclaimer: This simplified dimensional drawing does not show all details.

96004587 UNILIFT AP50B.50.08.1V 50 Hz

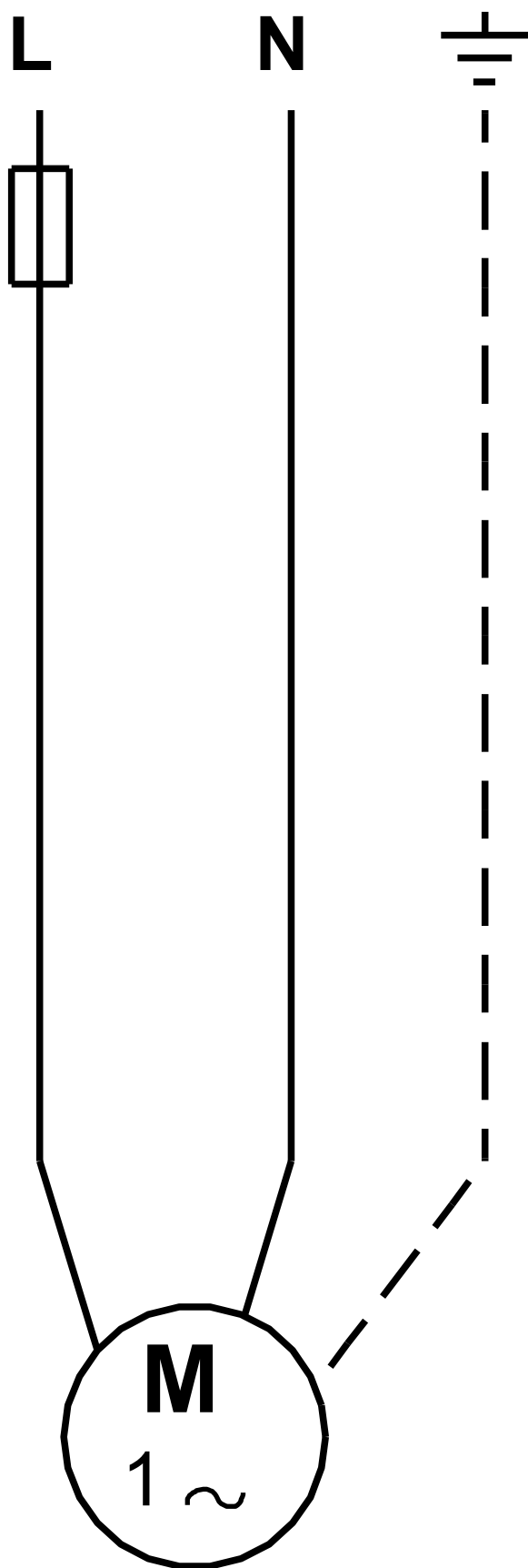

Note! All units are in [mm] unless others are stated.