

**Saku valla teede rekonstrueerimine; Köide IX – Riigi tee 11240
Tõdva - Hageri tee km 5,08 ülekäiguraja valgustus**

Edites OÜ

Contacts

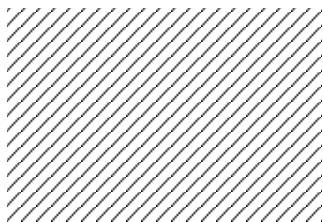

Edites OÜ

Product data sheet

Not yet a DIALux member - MRUE 035 757 L11 AA016_Bin-M_TH

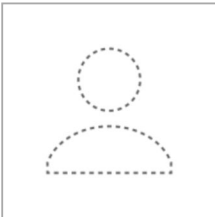

Article No.	Micro Martin 35 W 16 LEDs
P	35.0 W
Φ_{Lamp}	5228 lm
$\Phi_{Luminaire}$	5228 lm
η	100.00 %
Luminous efficacy	149.4 lm/W
CCT	5700 K
CRI	70

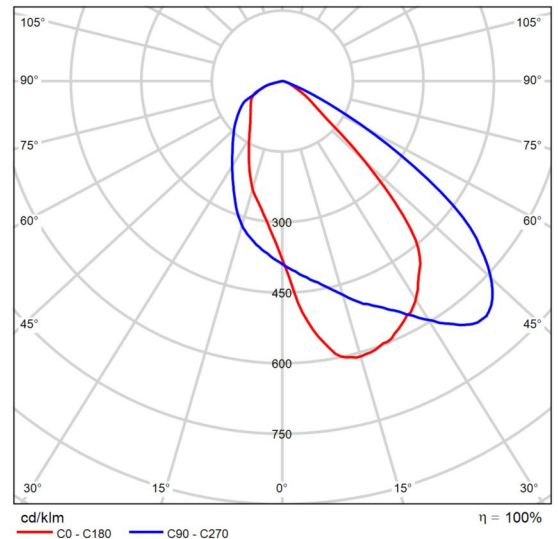

Polar LDC

Site 1

Luminaire layout plan

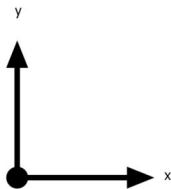

Site 1

Luminaire layout plan

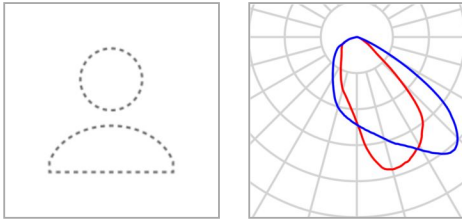

Manufacturer	Not yet a DIALux member	P	35.0 W
Article No.	Micro Martin 35 W 16 LEDs	$\Phi_{\text{Luminaire}}$	5228 lm
Article name	MRUE 035 757 L11 AA016_Bin-M_TH		
Fitting	1x 16 LEDs bin M		

Individual luminaires

X	Y	Mounting height	Luminaire
10.132 m	7.127 m	6.000 m	1
12.339 m	14.846 m	6.000 m	2

Site 1

Luminaire list

Φ_{total} 10456 lm	P_{total} 70.0 W	Luminous efficacy 149.4 lm/W
----------------------------	-----------------------	---------------------------------

pcs.	Manufacturer	Article No.	Article name	P	Φ	Luminous efficacy
2	Not yet a DIALux member	Micro Martin 35 W 16 LEDs	MRUE 035 757 L11 AA016_Bin-M_TH	35.0 W	5228 lm	149.4 lm/W

Site 1 (Light scene 1)

Calculation objects

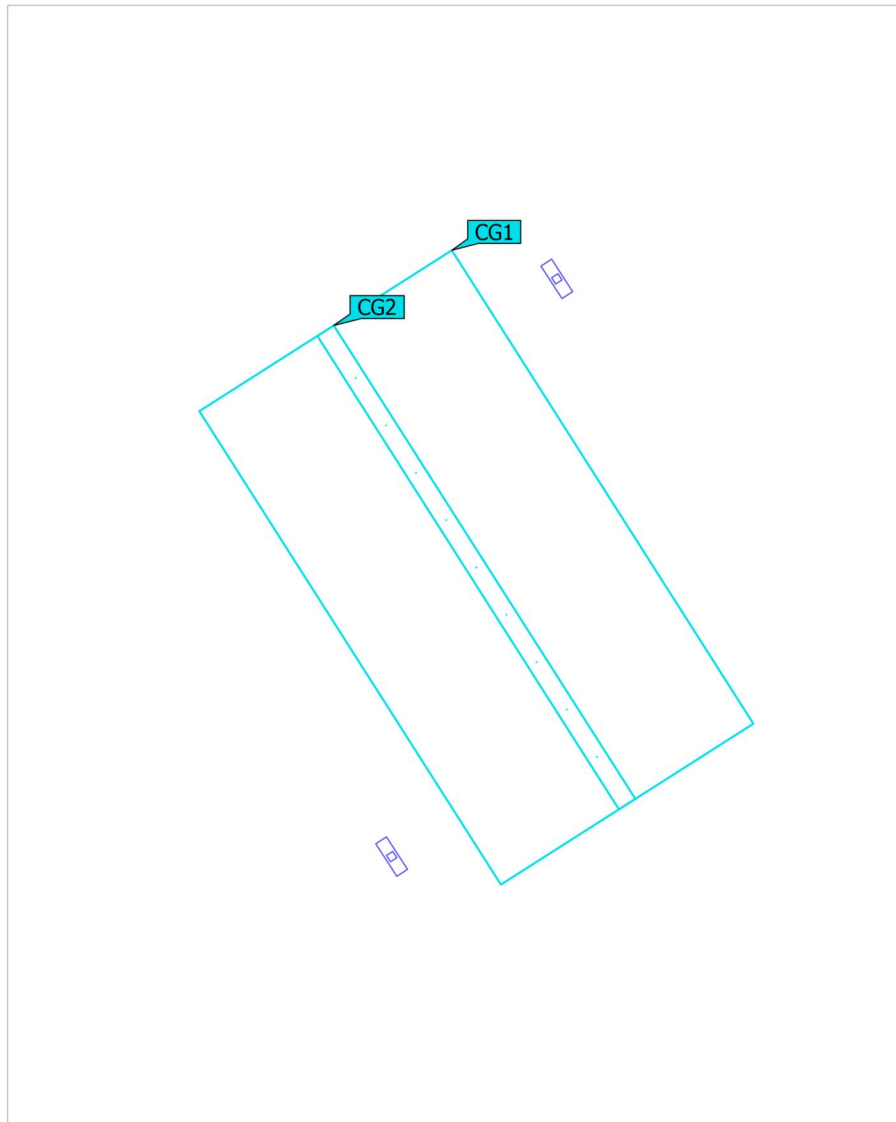

Site 1 (Light scene 1)

Calculation objects

Calculation surfaces

Properties	\bar{E}	E_{min}	E_{max}	g_1	g_2	Index
Nurgapunktid Vertical illuminance Rotation: 33.0°, Height: 1.000 m	17.6 lx	5.98 lx	35.1 lx	0.34	0.17	CG1
Nurgapunktid Vertical illuminance Rotation: -147.0°, Height: 1.000 m	17.8 lx	6.41 lx	35.4 lx	0.36	0.18	CG1
Keskterg Vertical illuminance Rotation: 33.0°, Height: 1.000 m	30.0 lx	8.87 lx	43.6 lx	0.30	0.20	CG2
Keskterg Vertical illuminance Rotation: -147.0°, Height: 1.000 m	30.0 lx	8.89 lx	43.7 lx	0.30	0.20	CG2

Utilisation profile: DIALux presetting (5.1.4 Standard (outdoor transportation area))

Site 1 (Light scene 1)

Nurgapunktid

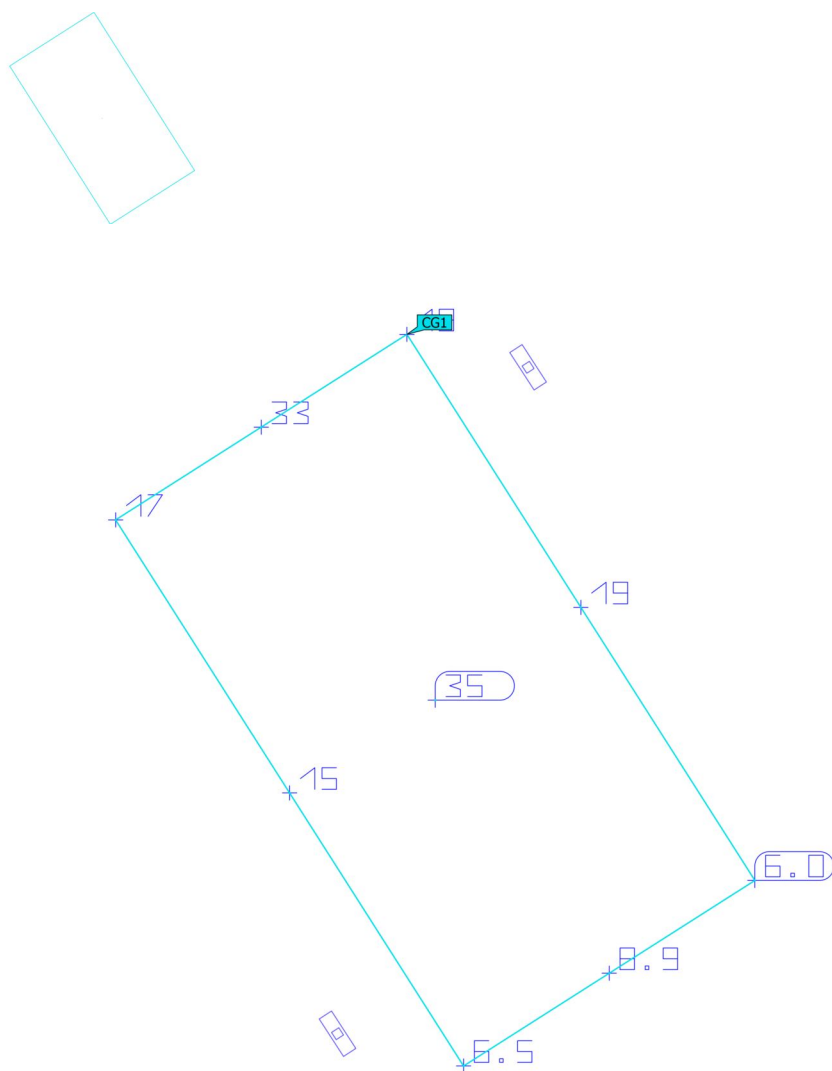

Properties	\bar{E}	E_{min}	E_{max}	g_1	g_2	Index
Nurgapunktid Vertical illuminance Rotation: 33.0°, Height: 1.000 m	17.6 lx	5.98 lx	35.1 lx	0.34	0.17	CG1

Utilisation profile: DIALux presetting (5.1.4 Standard (outdoor transportation area))

Site 1 (Light scene 1)

Nurgapunktid

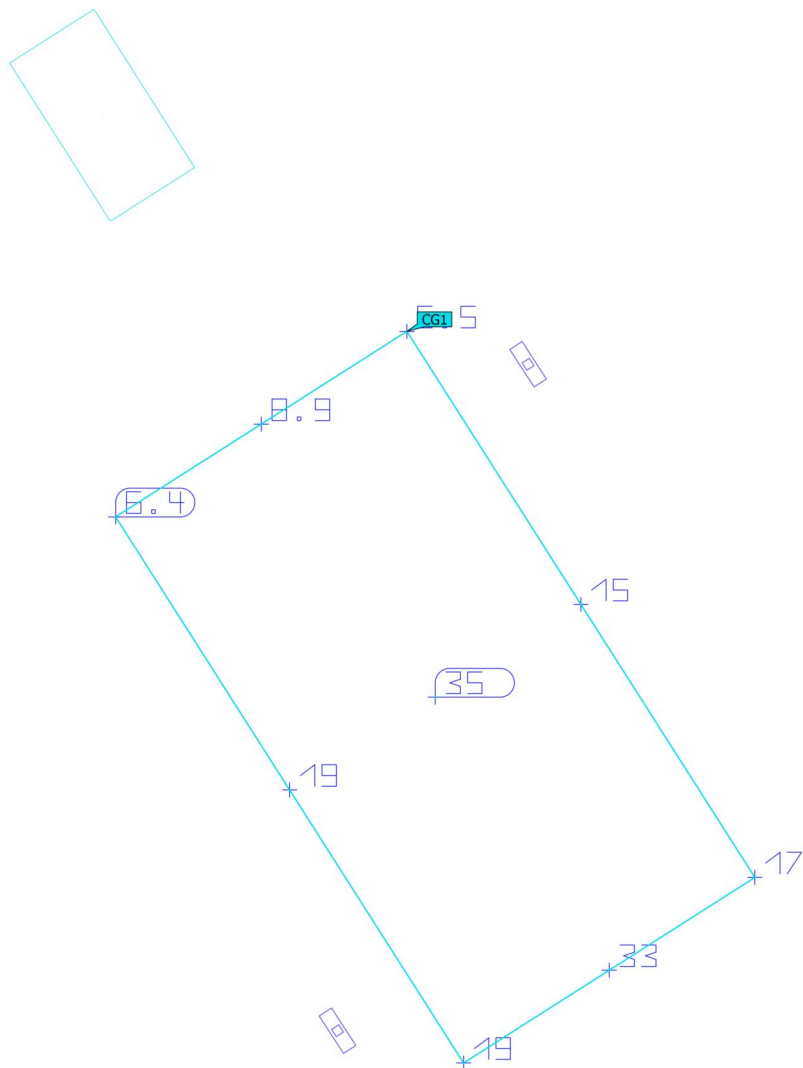

Properties	\bar{E}	E_{min}	E_{max}	g_1	g_2	Index
Nurgapunktid Vertical illuminance Rotation: -147.0°, Height: 1.000 m	17.8 lx	6.41 lx	35.4 lx	0.36	0.18	CG1

Utilisation profile: DIALux presetting (5.1.4 Standard (outdoor transportation area))

Site 1 (Light scene 1)

Keskteleg

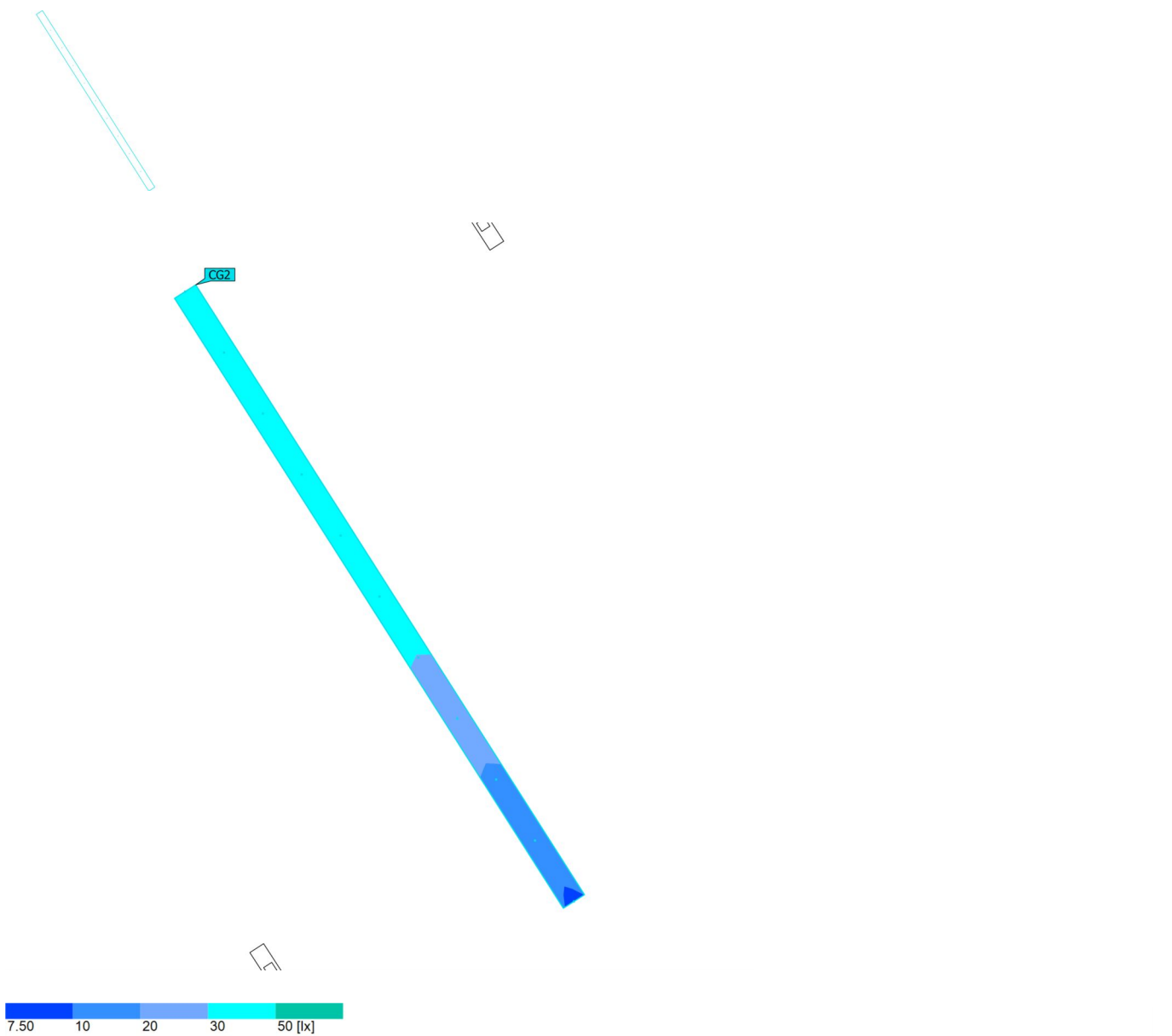

Properties	\bar{E}	E_{min}	E_{max}	g_1	g_2	Index
Keskteleg Vertical illuminance Rotation: 33.0°, Height: 1.000 m	30.0 lx	8.87 lx	43.6 lx	0.30	0.20	CG2

Utilisation profile: DIALux presetting (5.1.4 Standard (outdoor transportation area))

Site 1 (Light scene 1)

Kesktelg

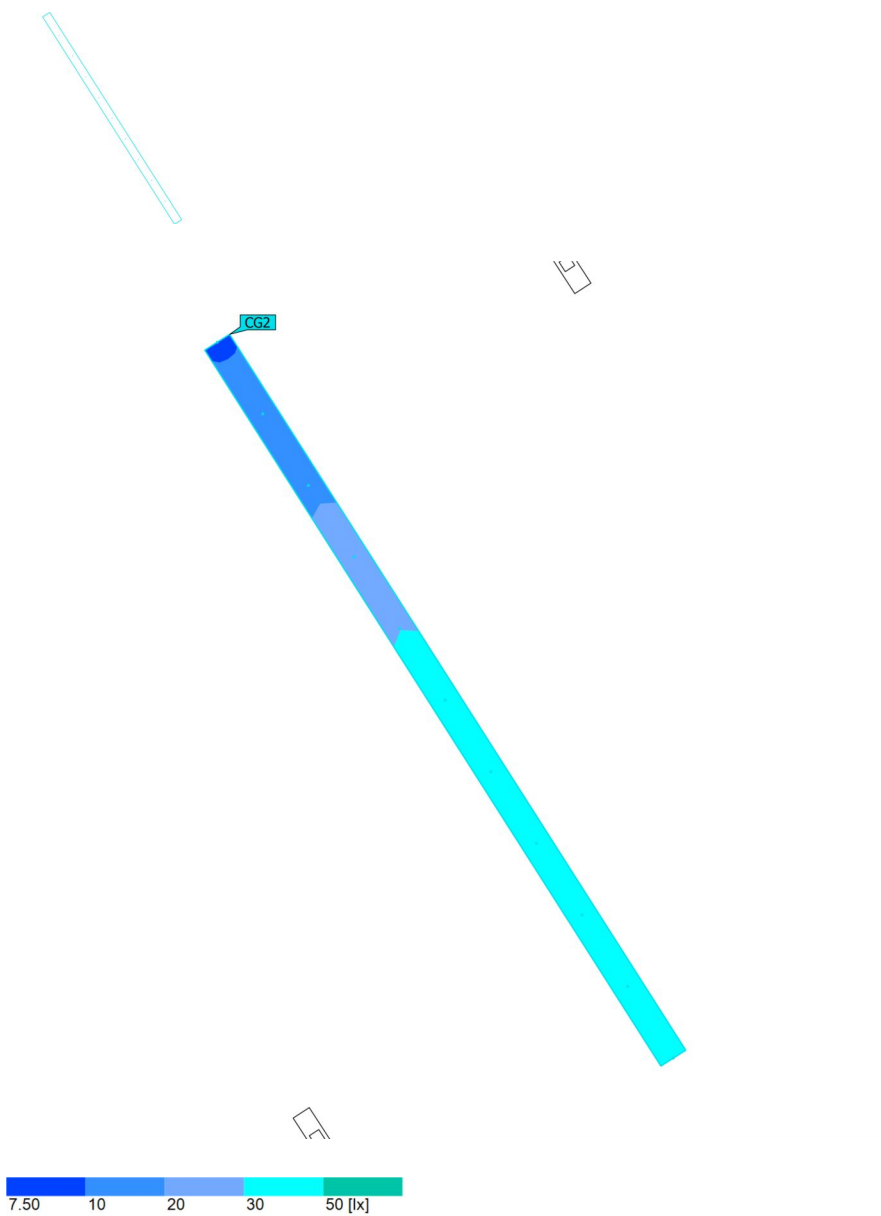

Properties	\bar{E}	E_{min}	E_{max}	g_1	g_2	Index
Kesktelg Vertical illuminance Rotation: -147.0°, Height: 1.000 m	30.0 lx	8.89 lx	43.7 lx	0.30	0.20	CG2

Utilisation profile: DIALux presetting (5.1.4 Standard (outdoor transportation area))