

Description	Value
General information:	
Product name:	SE1.80.100.15.4.50D.B
Product No:	96048005
EAN number:	5700395062694
Price:	€ 3605.7
Technical:	
Actual calculated flow:	12.7 l/s
Maximum flow:	35.6 l/s
Resulting head of the pump:	6 m
Maximum head:	8 m
Type of impeller:	S-TUBE
Max. Particle:	80 mm
Max. hydraulic efficiency:	72 %
Approvals:	EN12050-1
Curve tolerance:	ISO9906:2012 3B2
Cooling jacket (Yes/No):	Y
Materials:	
Pump housing:	Cast iron
Pump housing:	EN 1561 EN-GJL-250
Impeller:	Cast iron
Impeller:	EN 1561 EN-GJL-250
Shaft seal:	SiC/SiC
Secondary shaft seal:	CER/CARNBR
Installation:	
Range of ambient temperature:	0 .. 40 °C
Maximum operating pressure:	6 bar
Type of inlet connection:	DIN
Type of outlet connection:	DIN
Size of inlet connection:	DN 100
Size of outlet connection:	DN 100
Pressure rating for outlet connection:	PN 10
Maximum installation depth:	7 m
Inst dry/wet:	DRY/SUBMERGED
Installation:	H/V
Auto coupling:	96090994
Liquid:	
Liquid temperature range:	10 .. 40 °C
Selected liquid temperature:	20 °C
Density:	1000 kg/m³
Electrical data:	
Power input P1:	2.1 kW
Rated power - P2:	1.5 kW
Mains frequency:	50 Hz
Rated voltage:	3 x 380-415 V
Voltage tolerance:	+6/-10 %
Max starts per hour:	20
Rated current:	4.2 A
Rated current at 3/4 load:	3.4 A
Rated current at 1/2 load:	3 A
Starting current:	22 A
Rated current at no load:	2.5 A
Cos phi - power factor:	0.76
Cos phi - p.f. at no load:	0.15
Cos phi - p.f. at 3/4 load:	0.68
Cos phi - p.f. at 1/2 load:	0.56
Rated speed:	1435 rpm
Locked-rotor torque:	23 Nm
Breakdown torque:	28 Nm

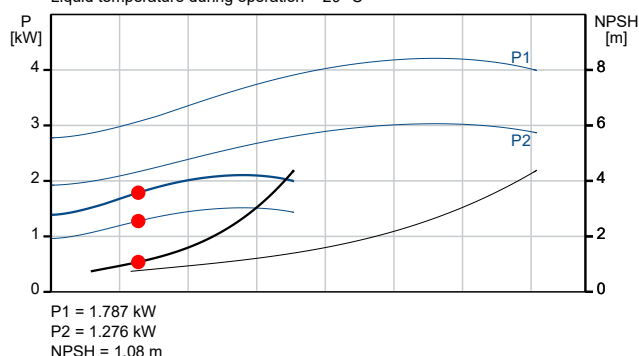

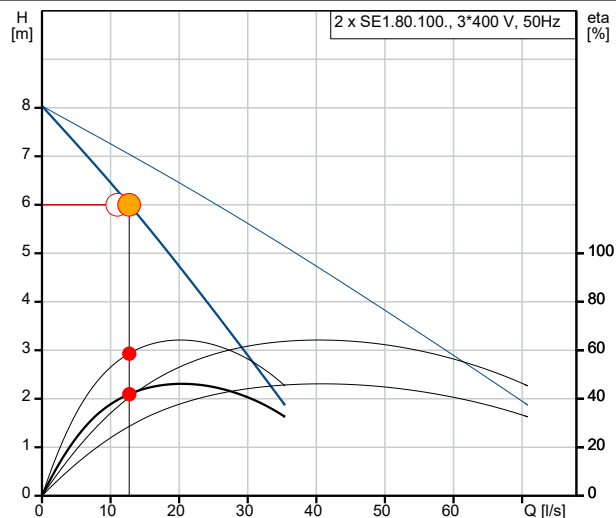

Company name:

Created by:

Phone:

Date:

09/03/2024

Description	Value
Moment of Inertia:	0.0468 kg m ²
Motor efficiency at full load:	72 %
Motor efficiency at 3/4 load:	71 %
Motor efficiency at 1/2 load:	67 %
Number of poles:	4
Method of start:	Direct-on-line (DOL)
Enclosure class (IEC 34-5):	IP68
Insulation class (IEC 85):	F
Explosion proof:	no
Built-in motor protection:	PTO
Thermal protection:	Internal
Power cable type:	Lyniflex
Length of power cable:	10 m
Power plug:	No plug
Controls:	
Control box:	N
Moisture sensor:	N
Water-in-oil sensor:	N
Temp. sensor:	N
Others:	
Net weight:	111 kg
Gross weight:	122 kg
Danish VVS No.:	391286256
Country of origin:	HU
Custom tariff no.:	84137021

96048005 SE1.80.100.15.4.50D.B 50 Hz

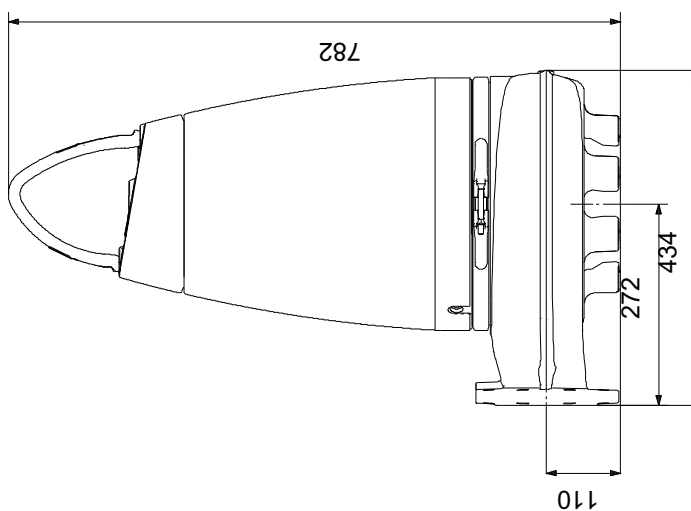
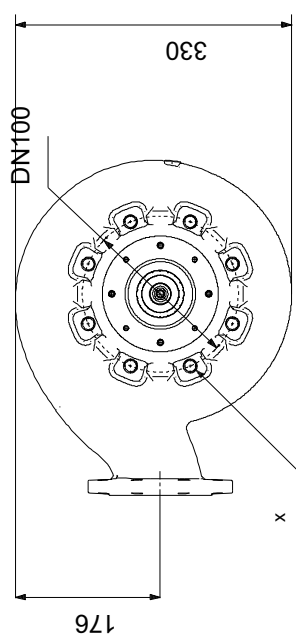
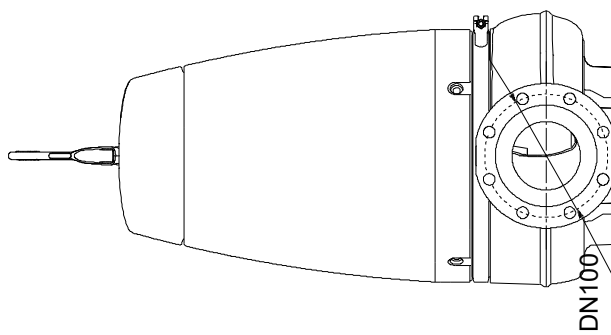
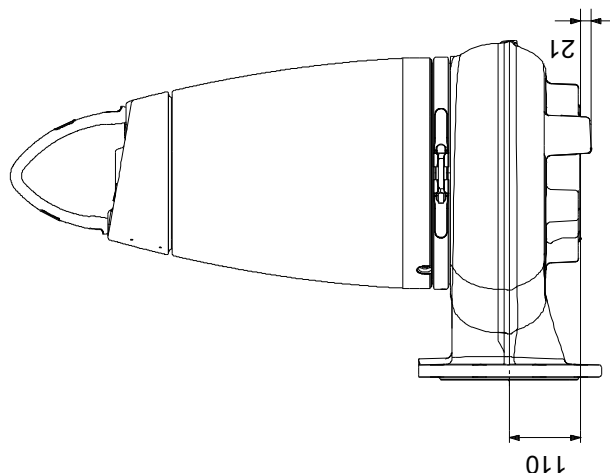

Note! All units are in [mm] unless others are stated.
Disclaimer: This simplified dimensional drawing does not show all details.

96048005 SE1.80.100.15.4.50D.B 50 Hz

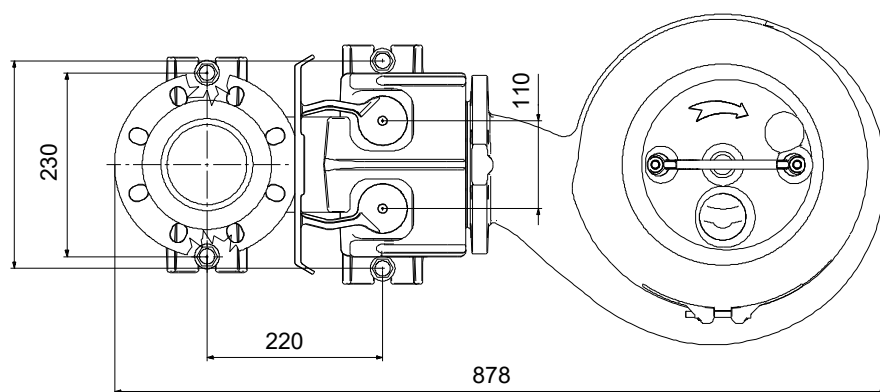
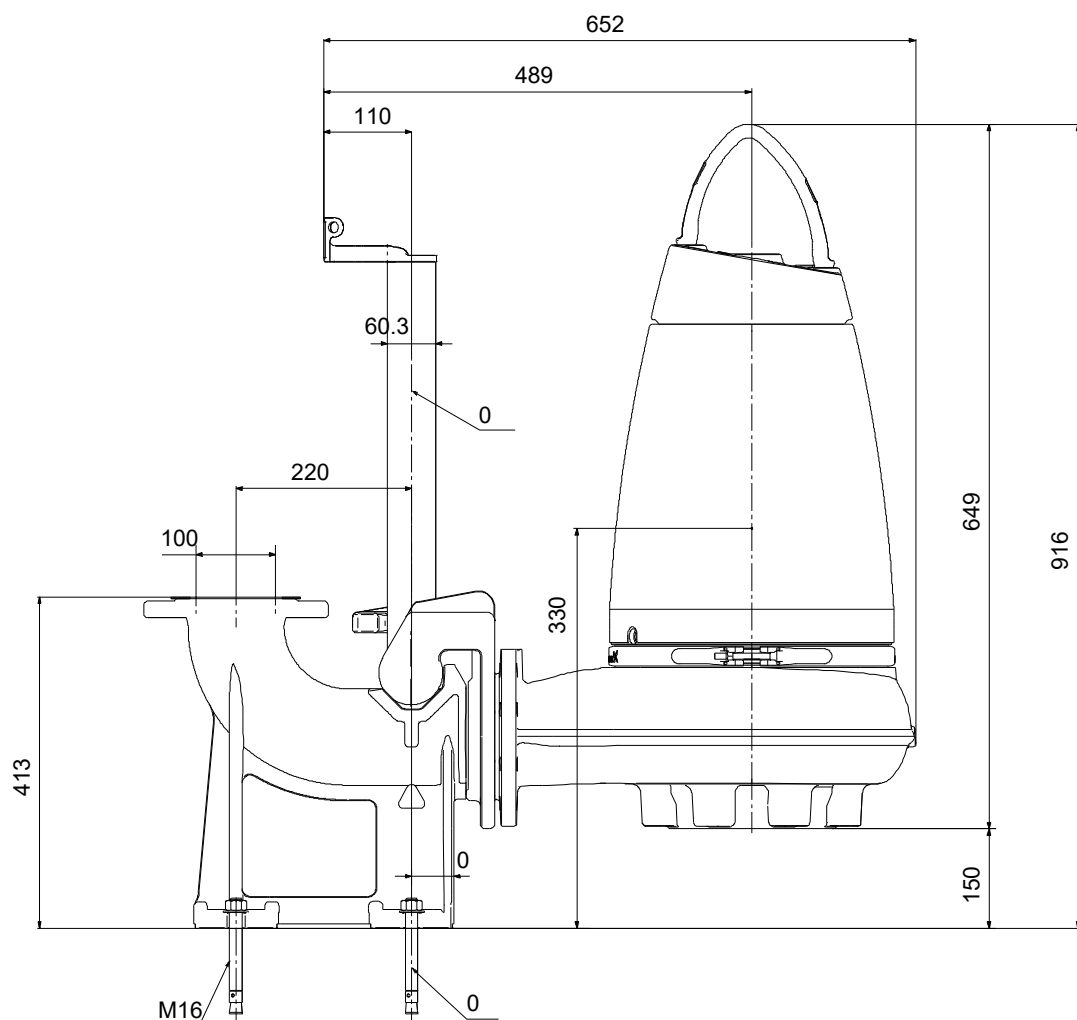

Note! All units are in [mm] unless others are stated.
Disclaimer: This simplified dimensional drawing does not show all details.

96048005 SE1.80.100.15.4.50D.B 50 Hz

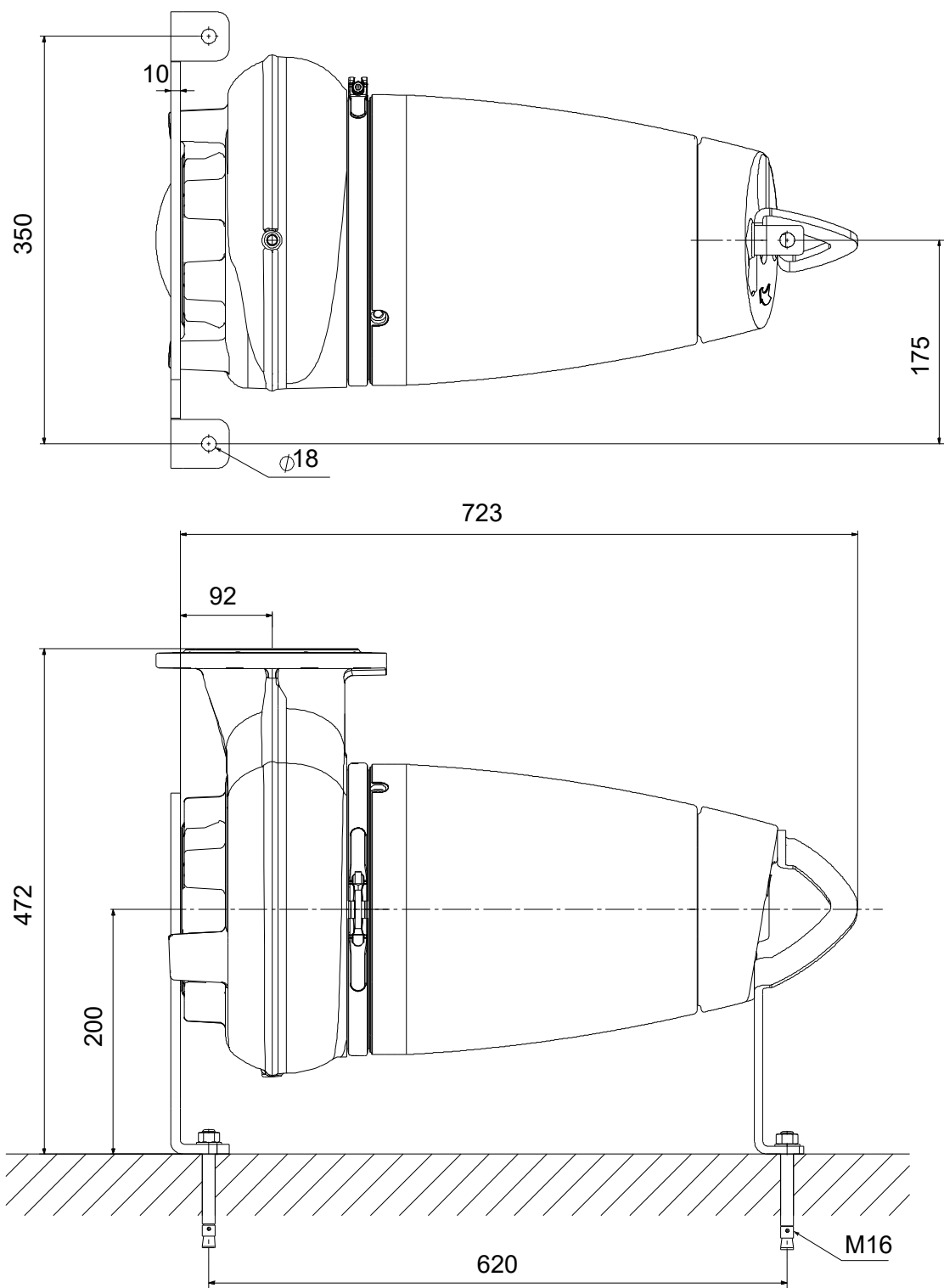

Note! All units are in [mm] unless others are stated.

Disclaimer: This simplified dimensional drawing does not show all details.

96048005 SE1.80.100.15.4.50D.B 50 Hz

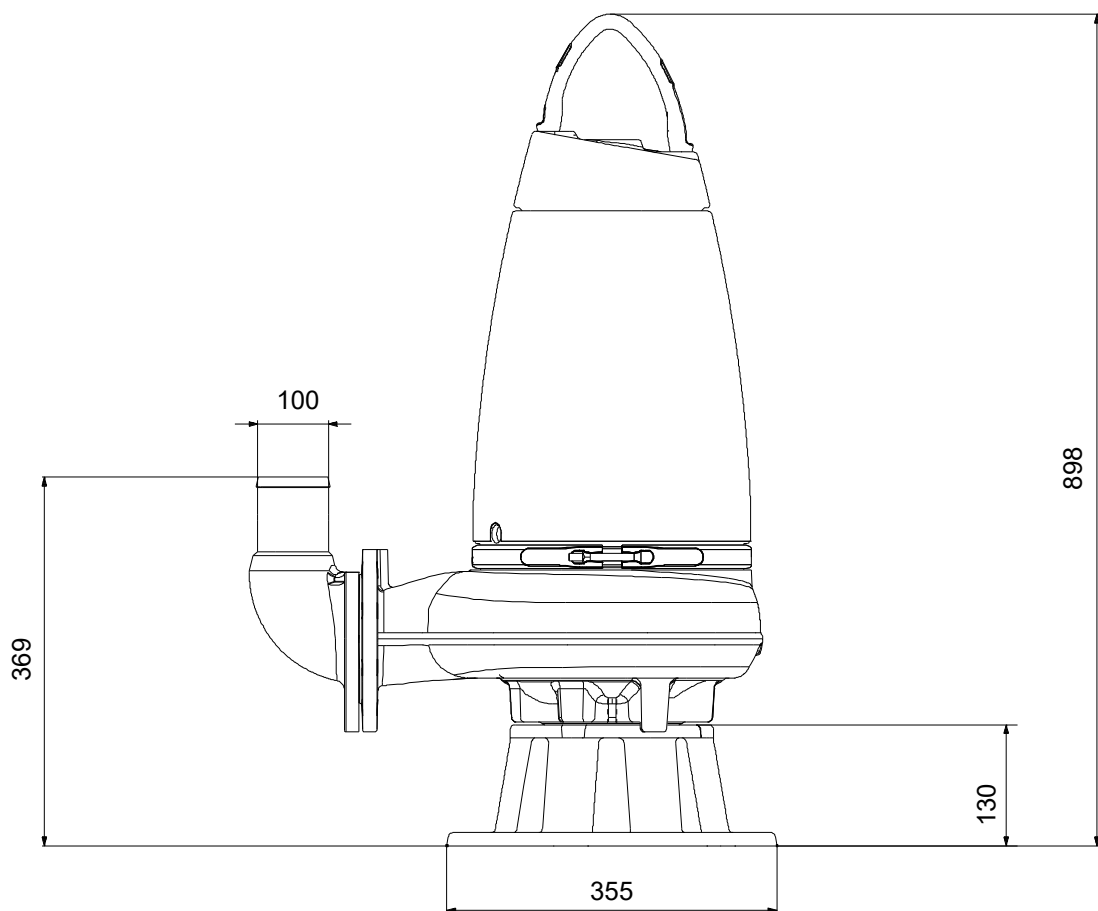
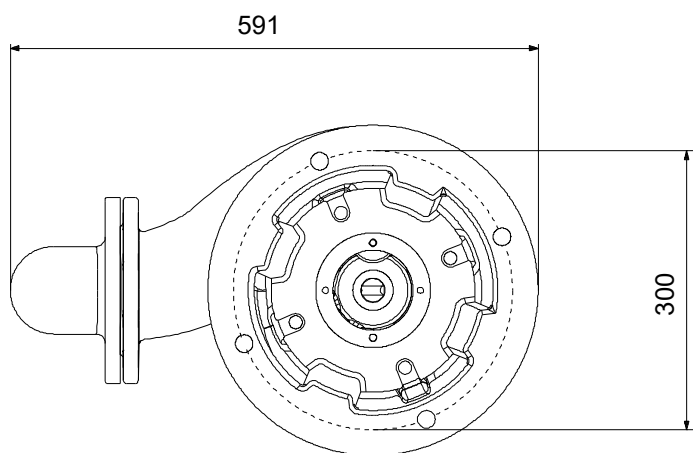

Note! All units are in [mm] unless others are stated.
Disclaimer: This simplified dimensional drawing does not show all details.

96048005 SE1.80.100.15.4.50D.B 50 Hz

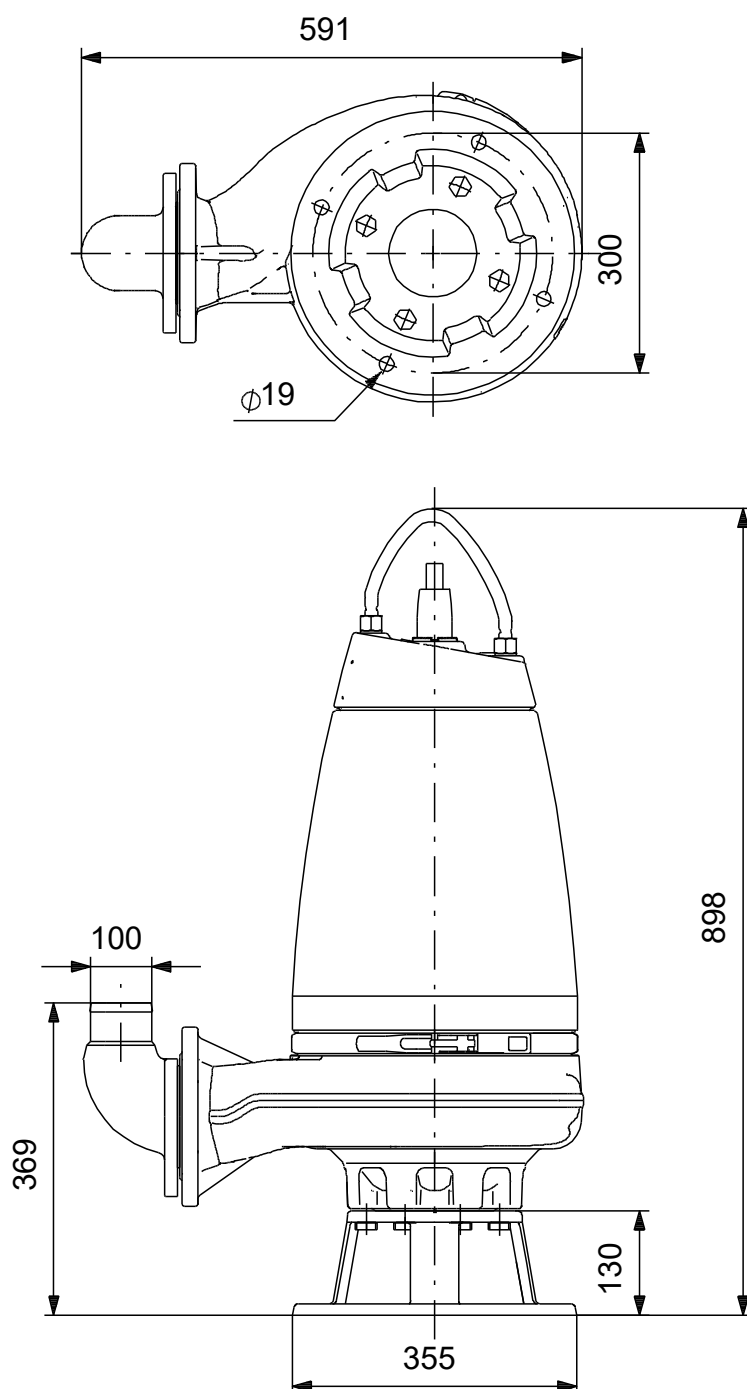

Note! All units are in [mm] unless others are stated.
Disclaimer: This simplified dimensional drawing does not show all details.

96048005 SE1.80.100.15.4.50D.B 50 Hz

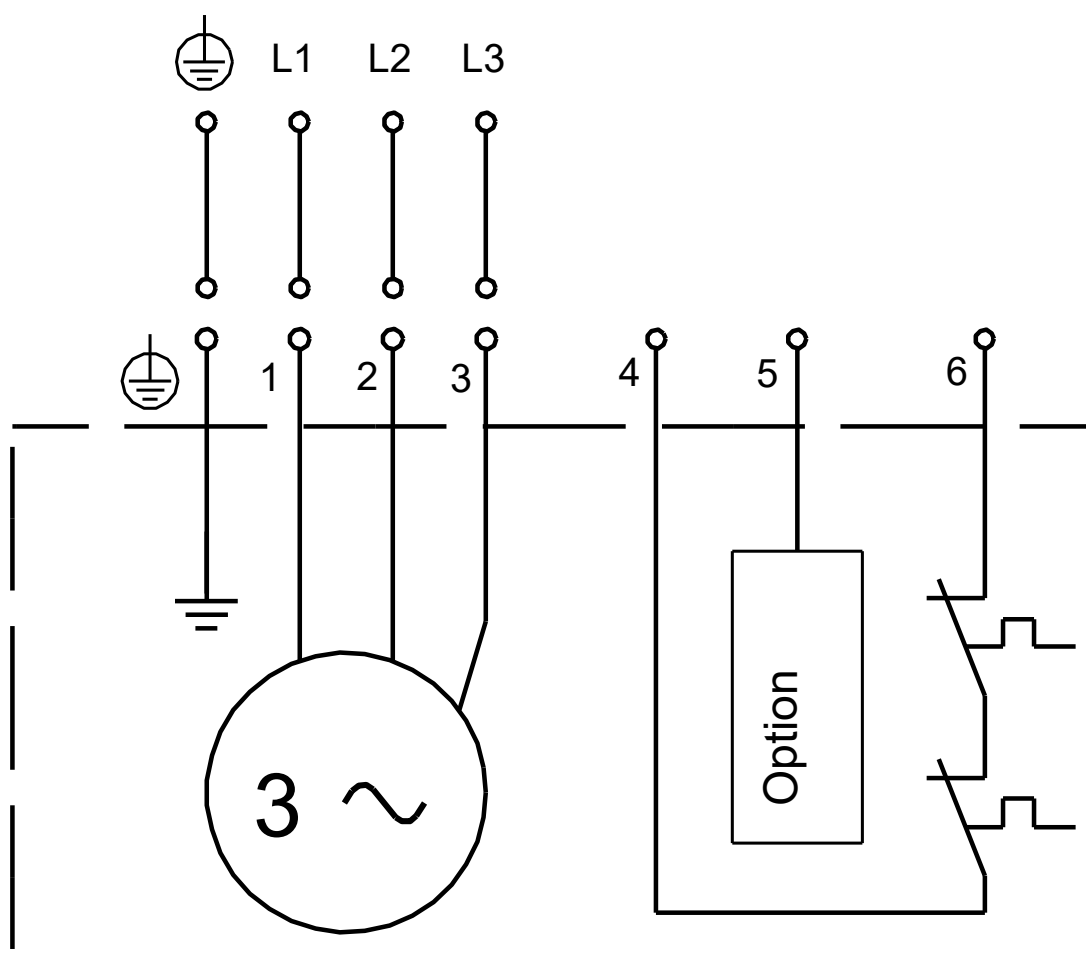
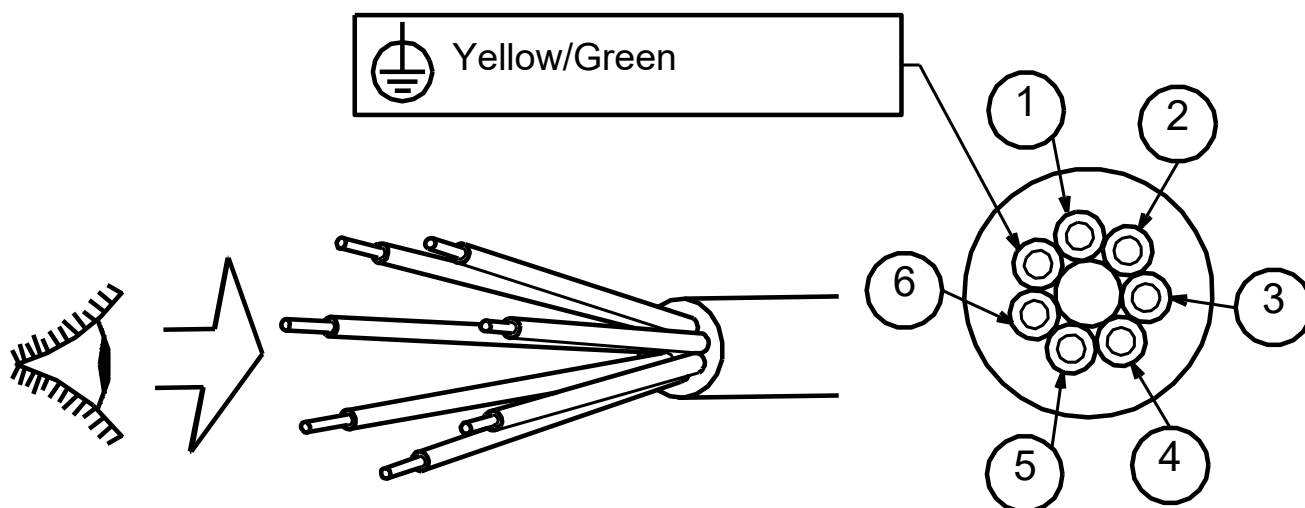

Note! All units are in [mm] unless others are stated.